

# DuraForm® EX Plastic



BDSYSTEMS™



*DuraForm® EX Plastic is available in both Natural and Black colors.*

Manufacture tough, impact-resistant plastic prototypes or end-use parts requiring molded-part performance and capable of withstanding harsh environments.

## Applications

- Complex, thin-walled ductwork
  - Motorsports
  - Aerospace
  - Unmanned air vehicles (UAV's)
- Housings and enclosures
- Impellers
- Connectors
- Consumer sporting goods
- Vehicle dashboards and grilles
- Bumpers
- Snap-fit designs
- Living hinges

## Features

- Outstanding toughness
- Excellent impact resistance
- Repeatable mechanical properties
- Easy-to-process
- Consistent black or natural color

## Benefits

- Parts have the toughness of injection molded ABS and polypropylene
- Functional prototypes can be tested in "real life" environments
- Complex end-use parts can be economically manufactured in low and medium volumes
- No painting required for black parts
- Unique properties create new business opportunities for service bureaus



Outstanding toughness.

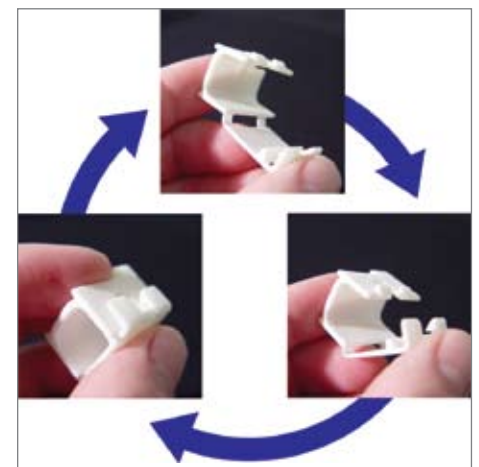

Tear-resistant living hinges survive hundreds of open-close cycles.

# DuraForm<sup>®</sup> EX Plastic

For use with all Sinterstation<sup>®</sup> Pro and Sinterstation<sup>®</sup> HiQ™ series SLS<sup>®</sup> Systems

## Minimum System Requirements

It is recommended that DuraForm<sup>®</sup> EX plastic be processed in a HiQ™-equipped system, which includes thermal controls. Software version 3.42 or higher (Sinterstation<sup>®</sup> HiQ™) or software version 3.545 or higher (Sinterstation<sup>®</sup> Pro) is required. SinterScan™ Software is highly recommended, and is required to maximize mechanical properties.



One-part black powder contributes to uniform black color.

### To order DuraForm<sup>®</sup> EX Natural plastic, please request part number:

|   |                        |
|---|------------------------|
| Sinterstation <sup>®</sup> HiQ™ SLS <sup>®</sup> Systems    | 24129-902 (10 kg)      |
| For Sinterstation <sup>®</sup> Pro SLS <sup>®</sup> Systems | 24129-901 (100 kg IPC) |

### To order DuraForm<sup>®</sup> EX Black plastic, please request part number:

|  |                        |
|--|------------------------|
| For Sinterstation <sup>®</sup> HiQ™ SLS <sup>®</sup> Systems | 24170-902 (10 kg)      |
| For Sinterstation <sup>®</sup> Pro SLS <sup>®</sup> Systems  | 24170-901 (100 kg IPC) |

## Technical Data

### General Properties

| Measurement                    | Condition | Metric                 | U.S.                   |
|--------------------------------|-----------|------------------------|------------------------|
| Specific Gravity               | ASTM D792 | 1.01 g/cm <sup>3</sup> | 1.01 g/cm <sup>3</sup> |
| Moisture Absorption - 24 hours | ASTM D570 | 0.48%                  | 0.48%                  |
| Moisture Saturation            | ASTM D570 | 1.15%                  | 1.15%                  |

### Mechanical Properties

| Measurement                            | Condition  | Metric   | U.S.          |
|--|------------|----------|---------------|
| Tensile Strength, Yield                | ASTM D638  | 37 MPa   | 5366 psi      |
| Tensile Strength, Ultimate             | ASTM D638  | 48 MPa   | 6961 psi      |
| Tensile Modulus                        | ASTM D638  | 1517 MPa | 220 ksi       |
| Elongation at Yield                    | ASTM D638  | 5%       | 5%            |
| Elongation at Break                    | ASTM D638  | 47%      | 47%           |
| Flexural Strength, Yield               | ASTM D790  | 42 MPa   | 6091 psi      |
| Flexural Strength, Ultimate            | ASTM D790  | 46 MPa   | 6672 psi      |
| Flexural Modulus                       | ASTM D790  | 1310 MPa | 190 ksi       |
| Hardness, Shore D                      | ASTM D2240 | 74       | 74            |
| Hardness, Rockwell L                   | ASTM D785  | 69       | 69            |
| Hardness, Rockwell M                   | ASTM D785  | 34       | 34            |
| Impact Strength (notched Izod, 23°C)   | ASTM D256  | 74 J/m   | 1.4 ft-lb/in  |
| Impact Strength (unnotched Izod, 23°C) | ASTM D256  | 1486 J/m | 27.8 ft-lb/in |
| Gardner Impact                         | ASTM D5420 | 11.8 J   | 8.7 ft-lb     |

### Thermal Properties

| Measurement                       | Condition                                 | Metric                     | U.S.                              |
|-----------------------------------|---|----------------------------|-----------------------------------|
| Heat Deflection Temperature (HDT) | ASTM D648<br>@ 0.45 MPa<br>@ 1.82 MPa     | 188 °C<br>48 °C            | 370 °F<br>118 °F                  |
| Coefficient of Thermal Expansion  | ASTM E831<br>@ 0 - 50 °C<br>@ 85 - 145 °C | 120 µm/m-°C<br>342 µm/m-°C | 66.7 µin/in-°F<br>190 µin/in-°F   |
| Specific Heat Capacity            | ASTM E1269                                | 1.75 J/g-°C                | 0.418 BTU/lb-°F                   |
| Thermal Conductivity              | ASTM E1225                                | 0.51 W/m-K                 | 3.5 BTU-in/hr-ft <sup>2</sup> -°F |
| Flammability                      | UL 94                                     | HB                         | HB                                |

### Electrical Properties

| Measurement                | Condition | Metric                        | U.S.                          |
|----------------------------|-----------|-------------------------------|-------------------------------|
| Volume Resistivity         | ASTM D257 | 1.3 X 10 <sup>13</sup> ohm-cm | 1.3 X 10 <sup>13</sup> ohm-cm |
| Surface Resistivity        | ASTM D257 | 4.9 X 10 <sup>12</sup> ohm    | 4.9 X 10 <sup>12</sup> ohm    |
| Dissipation Factor, 1 KHz  | ASTM D150 | 0.050                         | 0.050                         |
| Dielectric Constant, 1 KHz | ASTM D150 | 4.5                           | 4.5                           |
| Dielectric Strength        | ASTM D149 | 18.5 kV/mm                    | 470 kV/in                     |

Data was generated by building parts under typical default parameters. DuraForm<sup>®</sup> EX Plastic was processed on a base-level HiQ™ SLS<sup>®</sup> System at 13 watts laser power, 5 m/sec [200 inches/sec] scan speed, and a powder layer thickness of 0.1 mm [0.004 inches].



3D Systems Corporation  
333 Three D Systems Circle  
Rock Hill, SC 29730 U.S.A.

Tel: +1 803.326.4080  
Toll-free: 800.889.2964  
Fax: +1 803.324.8810

moreinfo@3dsystems.com  
www.3dsystems.com  
NASDAQ: TDSC

Warranty/Disclaimer: The performance characteristics of these products may vary according to product application, operating conditions, material combined with, or with end use. 3D Systems makes no warranties of any type, express or implied, including, but not limited to, the warranties of merchantability or fitness for a particular use.  
© 2008 by 3D Systems, Inc. All rights reserved. Specifications subject to change without notice. HiQ and SinterScan are trademarks, and the 3D logo, DuraForm, Sinterstation and SLS are registered trademarks of 3D Systems, Inc.